

BOTTOM VIEW

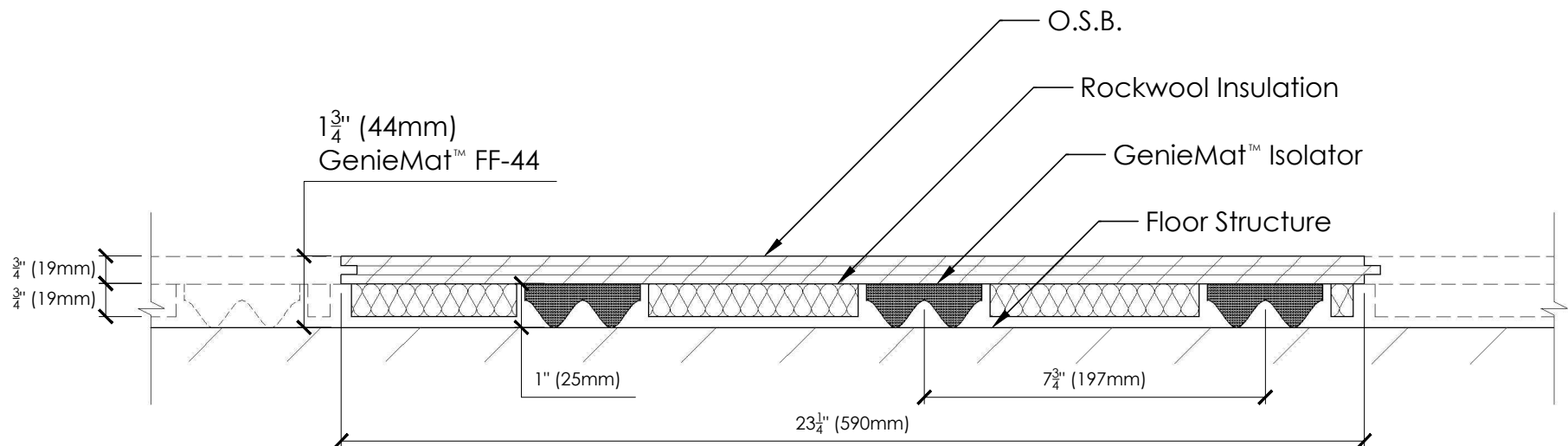

TOP VIEW



Phone: (416) 449 - 0049
Fax: (416) 849 - 0415

1370 Don Mills Rd, Unit 300
Toronto, ON M3B 3N7
Canada

GENERAL NOTES:

The information provided in this drawing is accurate to the best of our knowledge at the time of printing. However, we reserve the right to make changes when necessary without notification.

REVISIONS:

No.	Description:	Date:
1		
2		
3		
4		

PROJECT: Pliteq GenieMat™
Floating Floor Series

DRAWING: GenieMat™ FF-44

DRAWN BY: HMN

DATE: 2010-10-13

SCALE: N/A

DWG. NO.:
FF44